



## #240/241 Glacier Lodge Blackcomb Base

### Featuring

Located at the base of Blackcomb Mountain, the appealing Glacier Lodge offers owners and guests ski in/ski out convenience. This spacious 1 bedroom/2 bathroom lock off has 2 queen size beds and a pull out sofa bed enabling you to comfortably sleep six people. It is decorated in modern style and features a fully equipped kitchen, gas fireplace and private balcony. The property features a outdoor hot tub and heated pool; ski storage; bike storage; secured underground parking; front desk services. Unlimited owner use and nightly and long term rental permitted. Call today to view!





Enjoy the convenience and comfort of your own fully equipped kitchen, or dine out at one of Whistler top restaurants.

The suite comfortably sleeps 6 with 2 queen beds and a sofa bed. Enjoy a glass of wine as you cozy up in front of your gas fireplace.



Relax after a day on the mountain on your own private deck or head down to the pool or have a relaxing soak in the hot tub.



Professionally marketed by Dave Brown  
RE/MAX Sea to Sky Real Estate Whistler  
135-4370 Lorimer Road Whistler BC V0N 1B4 Canada  
Direct: 604-905-6317 Cell: 604-RE/905-8438 Fax: 604-932-4120  
Toll free: 1-888-689-0070 Email: [daveb@myseatosky.com](mailto:daveb@myseatosky.com)  
Web: [www.davesellswhistler.com](http://www.davesellswhistler.com)

SECOND FLOOR PLAN

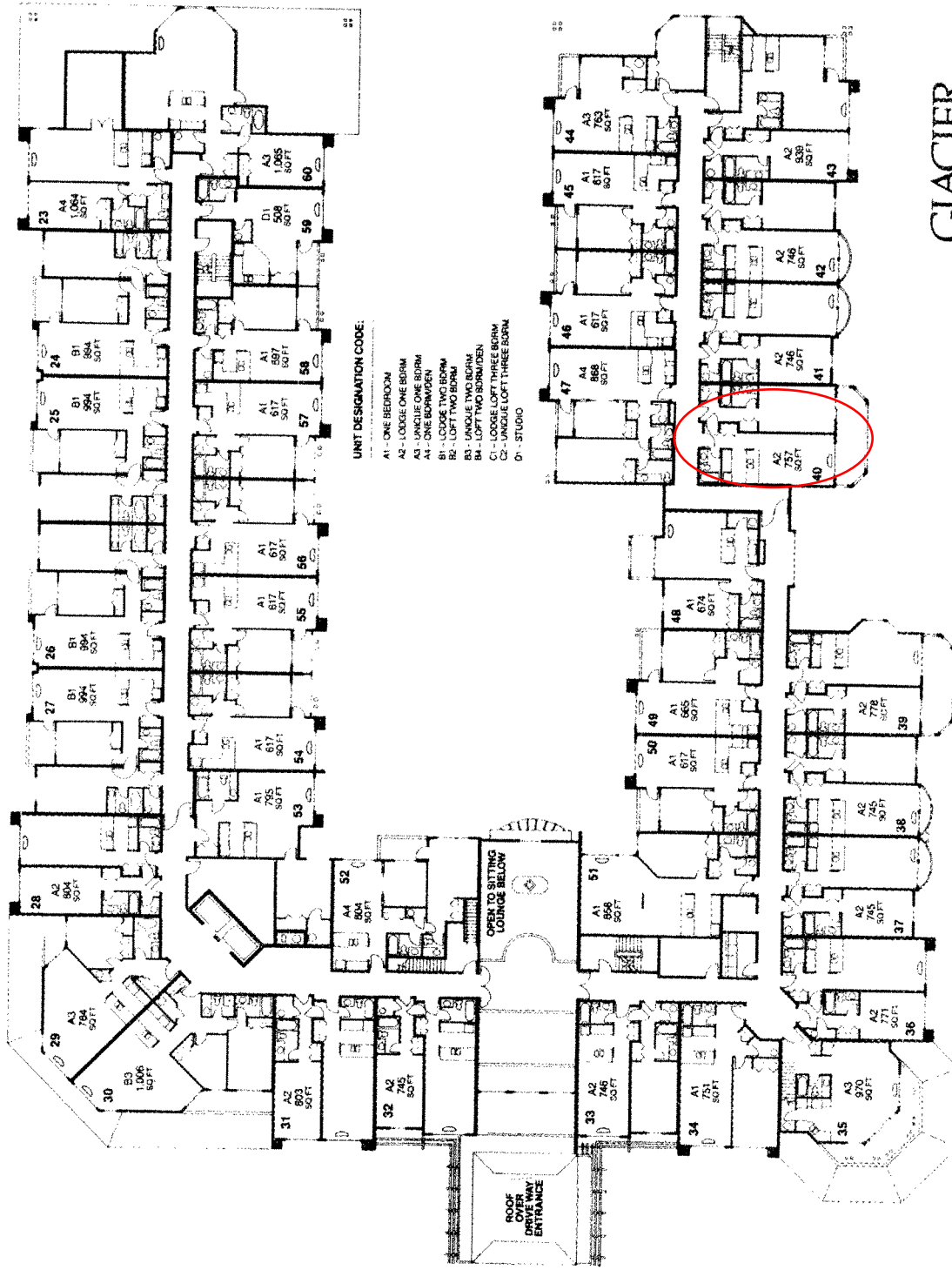

UNIT DESIGNATION CODE:

- A1 - ONE BEDROOM
- A2 - LODGE ONE BDRM
- A3 - LODGE ONE BDRM
- B1 - LODGE TWO BDRM
- B2 - LODGE TWO BDRM
- B3 - LODGE TWO BDRM
- B4 - LODGE TWO BDRM
- C1 - LODGE LOFT THREE BDRM
- C2 - LODGE LOFT THREE BDRM
- D1 - STUDIO

**GLACIER LODGE**  
 SECOND FLOOR  
 UNITS 23 TO 60 INCLUSIVE  
 NOT TO SCALE

